

FITTING INSTRUCTIONS FOR WATER CRAFT CARRIER

Product Code Number:

RCWCC

Fitting Instruction Sheet No.

100

ISSUE: H
23/11/04

Read these Fitting Instructions thoroughly before commencing installation.

FITTING PROCEEDURE

- 1 Decide upon location of Craft, preferably the vehicle passenger side for safer loading/unloading.
- 2 Fit lower Clamp Halves around Cross Bar whilst capturing flange of Swivel Peg (Rungs on Swivel Peg face towards each other).
- 3 Fit Special Bolt and Washer through Clamp Halves and engage Square Nut. Check alignment and positioning then tighten with Key provided.

FITTING WATER CRAFT

- 1 Unbuckle Webbing and lay open on vehicle. Position Craft onto Water Craft Carrier. **NOTE:** Hollow craft such as canoes should be carried upside-down so as to prevent filling with water should rain occur.
- 2 Wrap the Webbing around the Craft and fasten loosely using the quick release Buckle. The Swivel Peg can rotate 360 degrees to enable the Cushions to be aligned with the Craft surface.
- 3 Lift the Craft as you pull the Webbing tight. The Craft should be suspended off the Cross Bars when the Webbing is tight (See Fig. 2 & 3). Tie off extra Webbing.
- 4 Use the loose Tie Down Straps supplied to further secure the Craft to the Cross Bars (Fig. 2, 3 & 4).

USAGE INSTRUCTIONS

Depending on the size and shape of the water craft, the Cushions and Swivel Pegs can be set up as shown in either Fig. 2, 3 or 4. **(Distance changes between Swivel Pegs as does the orientation of the Cushions.)**

Before changing over configuration be sure to note the threading of the Webbing through windows of the Cushion. The Webbing must loop under Top Rung of Swivel Peg at the Location Notch (Fig. 1).

Roof load should not exceed the lesser permissible load rating stated in the vehicles manufacturers handbook or Roof Rack Fitting Instruction Sheet.

Loads should be evenly distributed and secured.

Any weight carried on the vehicle will adversely affect its handling particularly in cornering or in a cross wind and the vehicle should therefore be driven with increased caution.

Regularly check the tightness of the Roof Rack to the vehicle and the security of the load.

Long loads should always be additionally secured by tying down to the front and rear of the vehicle.

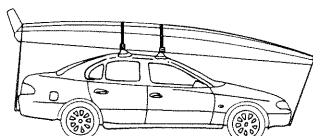

Be aware of the statutory requirements regarding maximum permissible projections from vehicles.

Fig. 1

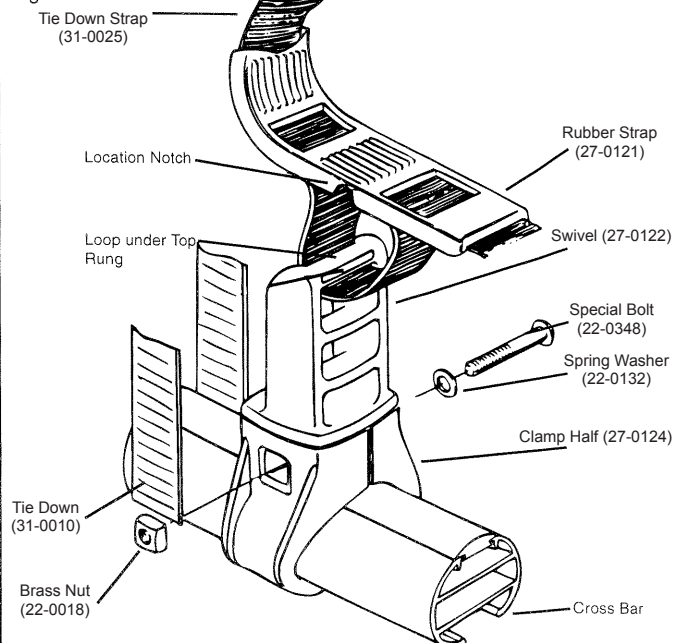

Fig. 2

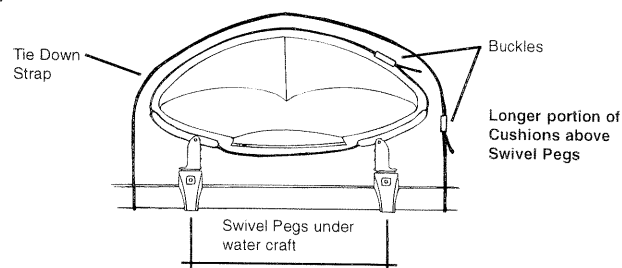

Fig. 3

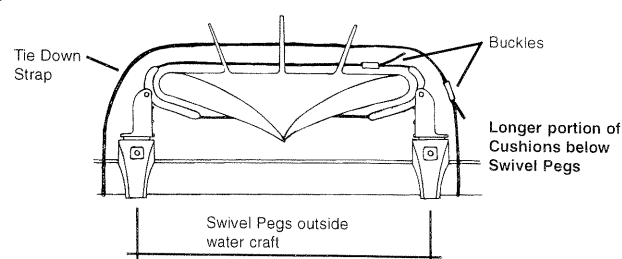
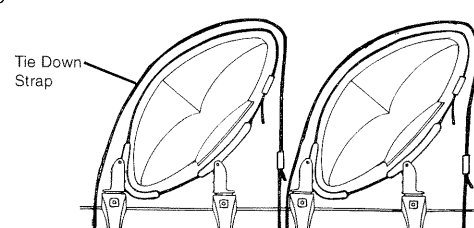

Fig. 4



ROLA
ROOF RACKS

www.rola.com.au