

**HAYMAN REESE**  
**PART No: R2713W**  
**AUDI Q7**

## INSTALLATION INSTRUCTIONS

PLEASE ENSURE THAT INSTRUCTIONS UNDERSTOOD PRIOR TO FITMENT



Installation Time: Approx **45** Mins

**Towbar Installation Instructions**  
**AUDI Q7**

**Towbar capacity**

**Part Number R2713W**

**Max Towing Braked 3500kg**  
**Max Static Ball Load 300kg**

Hayman Reese (Cequent)  
PO Box 4050, Dandenong South VIC 3164  
Phone 1800 812 017 Email [info@haymanreese.com.au](mailto:info@haymanreese.com.au)

# HAYMAN REESE

PART No: **R2713W**

**AUDI Q7**

## INSTALLATION INSTRUCTIONS

PLEASE ENSURE THAT INSTRUCTIONS UNDERSTOOD PRIOR TO FITMENT

### Warning:

1. Do not, drill, cut, weld or otherwise modify the towbar.
2. If you are using electric welding on a motor vehicle, **always** check that the vehicle is not equipped with electronic engine or instrument management equipment. Failure to do so could **destroy** any onboard computers. If in doubt, check with the vehicle's manufacturer.
1. **General:** Ensure all hardware items have been included refer to assembly diagram.
2. It is recommended that the instructions are read through and completely understood before making any attempt to fit this product.
3. Be wary of any changes to vehicle designs or other accessories that may conflict with the installation of this product.
4. Before drilling ensure that the area is clear of fuel, electrical & other components.
5. All holes drilled into the body panels shall have all burrs & swarf removed then coated with a suitable rust preventative paint.
6. The high tensile fasteners supplied with this product were used to achieve the specified rating. If replacement is required ensure that fasteners of the same rating & quality are used. Contact an authorised **Hayman Reese** dealer if further information is required.
7. Ensure that all hardware is fastened to torque list below check fasteners on regular basis.
8. Towbar load rating sticker provided with this product shall be conspicuously located on inside rear end of the driver's door. **(See diagram below).**
9. Hayman Reese recommends that you check your tow ball to ensure that it complies with the Australian standards **AS 4177.2**.
10. **PLEASE NOTE:** It is advised to remove your lug or tbm when not actually towing so as to produce a clear view of the vehicles registration plate if obscured, and to also provide maximum available departure angle.

### Tow bar Maintenance and Care.

Hayman Reese recommends that bolt torque's, as listed below, are routinely and regularly inspected and checked for correct tension. Replace any worn or defective parts.

We recommended to remove Tow Ball Mounts (TBM's, tongues or lugs) when not being used for any considerable length of time.

So as to avoid injury, when not towing it is suggested that the tongue, Pull Pin and R-clip are removed then stored in a safe, clean and dry place, away from excessive moisture.

Hitch Pull Pins and spring "R" clips are regularly checked for proper installation. Replace any worn or defective parts.

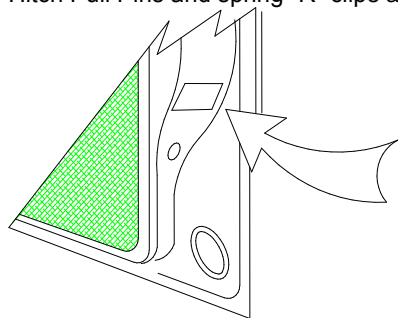

**Place load rating sticker  
inside driver's door here**

### **RECOMMENDED ASSEMBLY TORQUE LISTING**

#### Diameter Grade 8.8 Bolt

M6	9.5 Nm
M8	21.7 Nm
M10	43.4 Nm
M12	77.3 Nm
M14	146 Nm
M16	189.8 Nm

### **FOR TOWING PURPOSES ONLY**

**For towing capacity details please refer to vehicle owner's manual or to the manufacturer. Overloading can void your warranties.**

Issue Date **13/7/10**

Page 2

Part No: **R2713W**

# HAYMAN REESE

PART No: **R2713W**

**AUDI Q7**

## INSTALLATION INSTRUCTIONS

PLEASE ENSURE THAT INSTRUCTIONS UNDERSTOOD PRIOR TO FITMENT

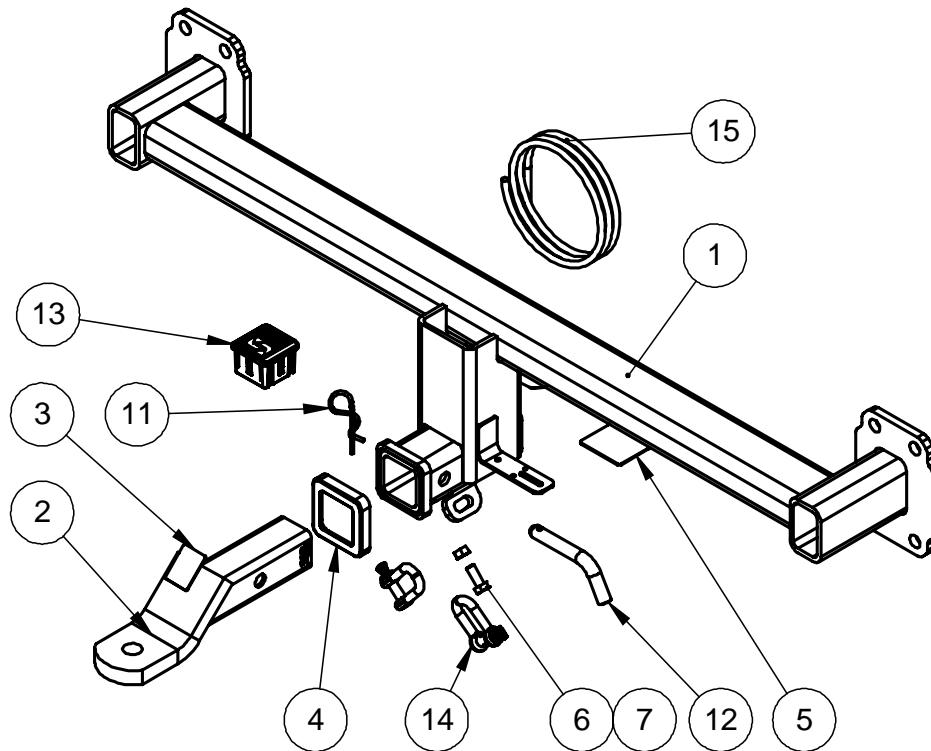

QTY.	DESCRIPTION	ITEM NO.
1	Q7 WELDED ASSY.	1
1	T.B.MOUNT 21161	2
1	H.R STICKER	3
1	Hitch Box Collar Cover	4
1	CP LABEL	5
1	BOLT M10-1.50 x 25	6
1	NUT HX M10 - 1.5 Z/P	7
1	FITTING INSTRUCTION	8
1	LOAD RATING LABEL	9
1	Warranty Card	10
1	SPRING COTTER PIN	11
1	PULL PIN	12
1	Hitch Box Cover	13
2	D' SHACKLE	14
1	WIRING LOOM	15





## HAYMAN REESE

PART No: **R2713W**

**AUDI Q7**

### INSTALLATION INSTRUCTIONS

PLEASE ENSURE THAT INSTRUCTIONS UNDERSTOOD PRIOR TO FITMENT

	<p>1. Remove torx screws around wheel arch and under the bumper profile.</p>
	<p>2. Lift floorboard and tray to remove 4 nuts holding the bumper on either side of the car. 3. Remove bumper and disconnect wiring to the bumper bar.</p>
	<p>4. Remove 8 bolts holding impact beam. Discard impact beam. Fit tow bar in place using the same bolts. Torque bolts to specification.</p>
	<p>5. Remove pop out window and refit the bumper bar.</p>

**HAYMAN REESE**  
**PART No: 100418-WL**  
**AUDI Q7**  
**2009 - Onwards**

## **INSTALLATION INSTRUCTIONS**

PLEASE ENSURE THAT INSTRUCTIONS ARE UNDERSTOOD PRIOR TO FITMENT

### **Wiring Loom Installation Instructions**

**AUDI Q7**  
**2009 - Onwards**  
**Part No: 100418-WL**  
**ECU: 04829**

**Tail Harness Length Required: 1800mm**

**For 2011 models: Page 5-6**  
**Red / Black wire needs to be extended 500mm.**

**Ensure tailgate remains closed during fitment to ensure  
that light signals remain on tailgate.**

**RPA can be disabled from the overhead switch.**

**Wiring Loom Installation Time: Approx 50 Mins**

Issue Date 22-12-11

Page 1

Part No: 100418-WL

Hayman Reese (Cequent)  
PO Box 4050, Dandenong South VIC 3164  
Phone 1800 812 017 Email [info@haymanreese.com.au](mailto:info@haymanreese.com.au)

[www.haymanreese.com.au](http://www.haymanreese.com.au)





**HAYMAN REESE**  
**PART No: 100418-WL**  
**AUDI Q7**  
**2009 - Onwards**

## **INSTALLATION INSTRUCTIONS**

**PLEASE ENSURE THAT INSTRUCTIONS ARE UNDERSTOOD PRIOR TO FITMENT**

1. In the luggage compartment, fold the rear seats (1) down flat.



2. Remove the carpet floor cover (1).



3. Remove the storage compartment tray (1).



**Issue Date 22-12-11**

**Page 2**

**Part No: 100418-WL**

Hayman Reese (Cequent)  
PO Box 4050, Dandenong South VIC 3164  
Phone 1800 812 017 Email [info@haymanreese.com.au](mailto:info@haymanreese.com.au)

[www.haymanreese.com.au](http://www.haymanreese.com.au)



**HAYMAN REESE**  
**PART No: 100418-WL**  
**AUDI Q7**  
**2009 - Onwards**

## **INSTALLATION INSTRUCTIONS**

**PLEASE ENSURE THAT INSTRUCTIONS ARE UNDERSTOOD PRIOR TO FITMENT**

4. Dislodge the rear trim (1) by first removing the four fasteners (2).

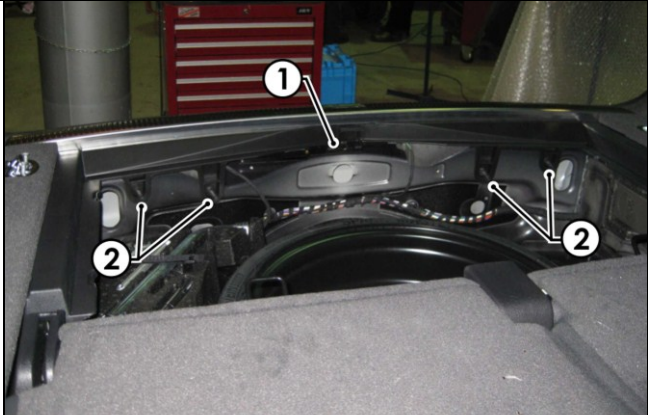

5. Disconnect the rear trim connector (1).

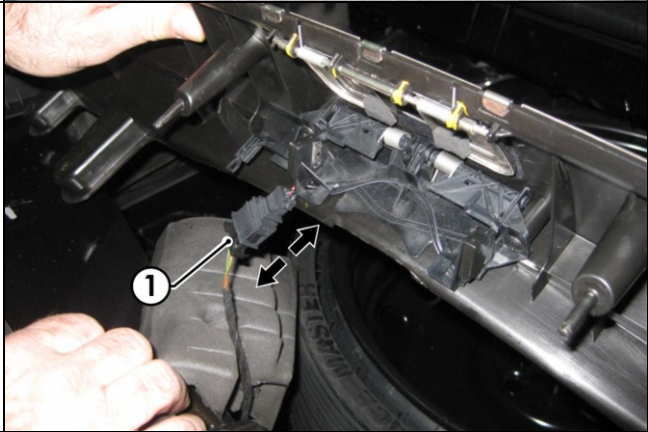

6. Remove the RHS floor carpet cover (1) by first removing the fasteners located underneath the cargo tie down hooks (2).

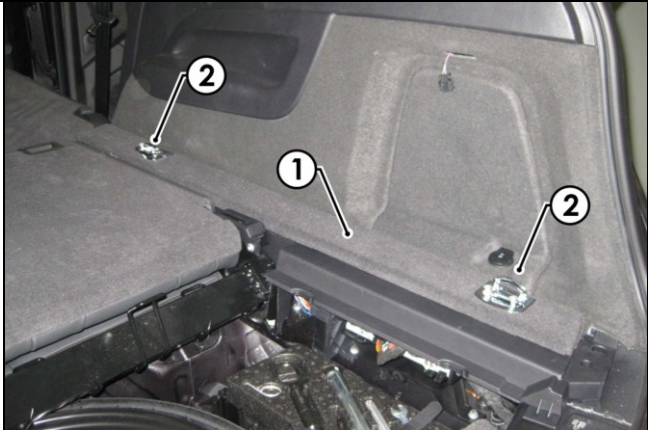

Issue Date 22-12-11

Page 3

Part No: 100418-WL

Hayman Reese (Cequent)  
PO Box 4050, Dandenong South VIC 3164  
Phone 1800 812 017 Email [info@haymanreese.com.au](mailto:info@haymanreese.com.au)

[www.haymanreese.com.au](http://www.haymanreese.com.au)



**HAYMAN REESE**  
**PART No: 100418-WL**  
**AUDI Q7**  
**2009 - Onwards**

## **INSTALLATION INSTRUCTIONS**

**PLEASE ENSURE THAT INSTRUCTIONS ARE UNDERSTOOD PRIOR TO FITMENT**

7. Remove the fastener (1) from the RHS upper trim.



8. Dislodge the RHS access panel cover (1).

9. Disconnect the AUX power socket connector (2).

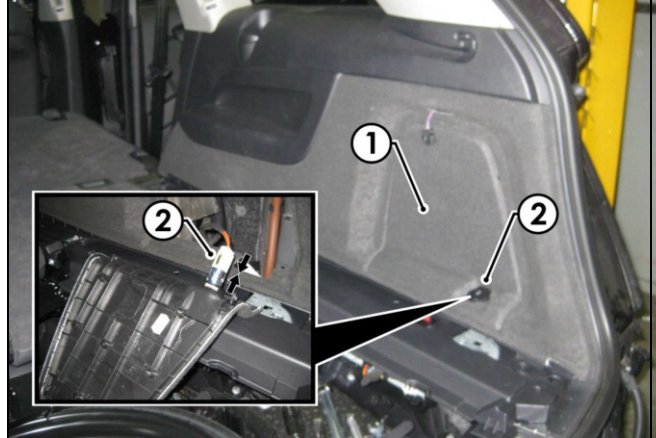

10. Disconnect the RHS light connector (1).

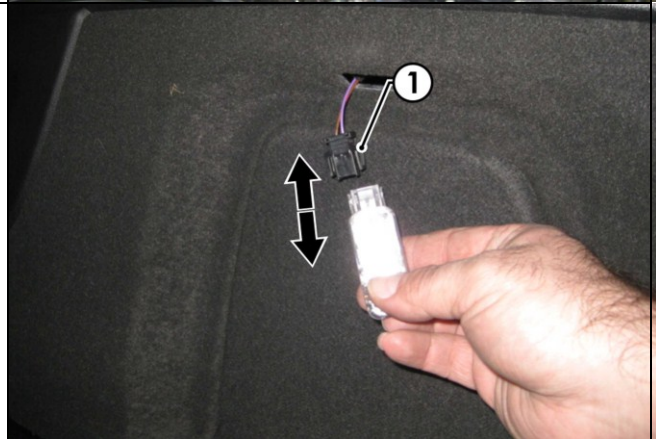

**Issue Date 22-12-11**

**Page 4**

**Part No: 100418-WL**

Hayman Reese (Cequent)  
PO Box 4050, Dandenong South VIC 3164  
Phone 1800 812 017 Email [info@haymanreese.com.au](mailto:info@haymanreese.com.au)

[www.haymanreese.com.au](http://www.haymanreese.com.au)





**HAYMAN REESE**  
**PART No: 100418-WL**  
**AUDI Q7**  
**2009 - Onwards**

## **INSTALLATION INSTRUCTIONS**

**PLEASE ENSURE THAT INSTRUCTIONS ARE UNDERSTOOD PRIOR TO FITMENT**

11. Dislodge the RHS side trim (1).

12. Remove the RHS lower trim (2).

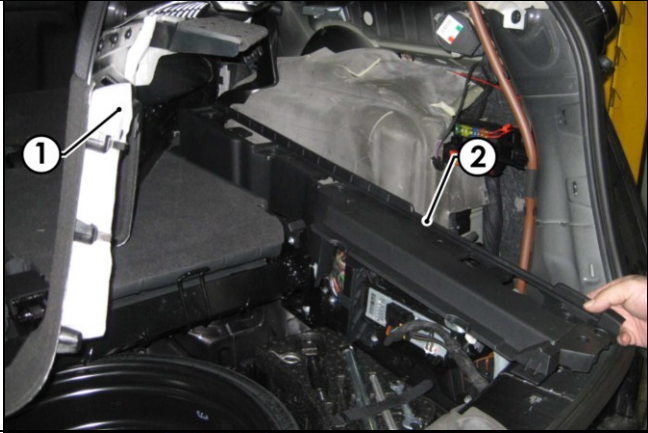

13. On the rear of the luggage compartment, reconnect the rear trim panel (1).

**Note: Ensure to reconnect the rear trim panel before continuing with any of the wiring fitment, this will ensure the micro switch will trigger the light output on the tailgate.**

**Note: Ensure tailgate remains open during fitment to ensure light signals remain on tailgate.**



14. Dislodge the vehicle ECU (1) to gain access to the connectors.



Issue Date 22-12-11

Page 5

Part No: 100418-WL

Hayman Reese (Cequent)  
PO Box 4050, Dandenong South VIC 3164  
Phone 1800 812 017 Email [info@haymanreese.com.au](mailto:info@haymanreese.com.au)

[www.haymanreese.com.au](http://www.haymanreese.com.au)



**HAYMAN REESE**  
**PART No: 100418-WL**  
**AUDI Q7**  
**2009 - Onwards**

## INSTALLATION INSTRUCTIONS

**PLEASE ENSURE THAT INSTRUCTIONS ARE UNDERSTOOD PRIOR TO FITMENT**

15. Following the table below, connect the ezy taps (4) to the vehicle harness wires (5) on the blue (2) & brown (1) connectors, then connect the trailer harness terminals (3) to the corresponding wires (5).

Trailer Patch	Vehicle Connector	Function	Connector / Terminal #
GREEN/BLACK	BLUE/RED	R.IND	BROWN / TERM. 9
YELLOW/BLACK	BLUE/RED	L.IND	BROWN / TERM. 11
BROWN/BLACK	GREY/YELLOW	TAIL	BROWN / TERM 12
RED/BLACK	BLACK/GREEN	BRAKE	BLUE

**Build Date 2011:**

Function	Trailer Patch	Vehicle Connector
R.IND	GREEN / BLACK	BLACK / GREEN
L.IND	YELLOW / BLACK	BLACK / WHITE
TAIL	BROWN / BLACK	WHITE / YELLOW

**For 2009 and 2011 models only.**

16. Connect the trailer harness ground ring terminal (2) to the vehicle stud (1) located behind the luggage compartment fuse panel, using an M6 nut (not supplied).

17. Route the trailer harness black/white reverse wire (1) down towards the RHS vehicle grommet.

**For 2011 models only.**

18. Route the trailer harness extended Red/Black wire (2) down towards the RHS vehicle grommet.

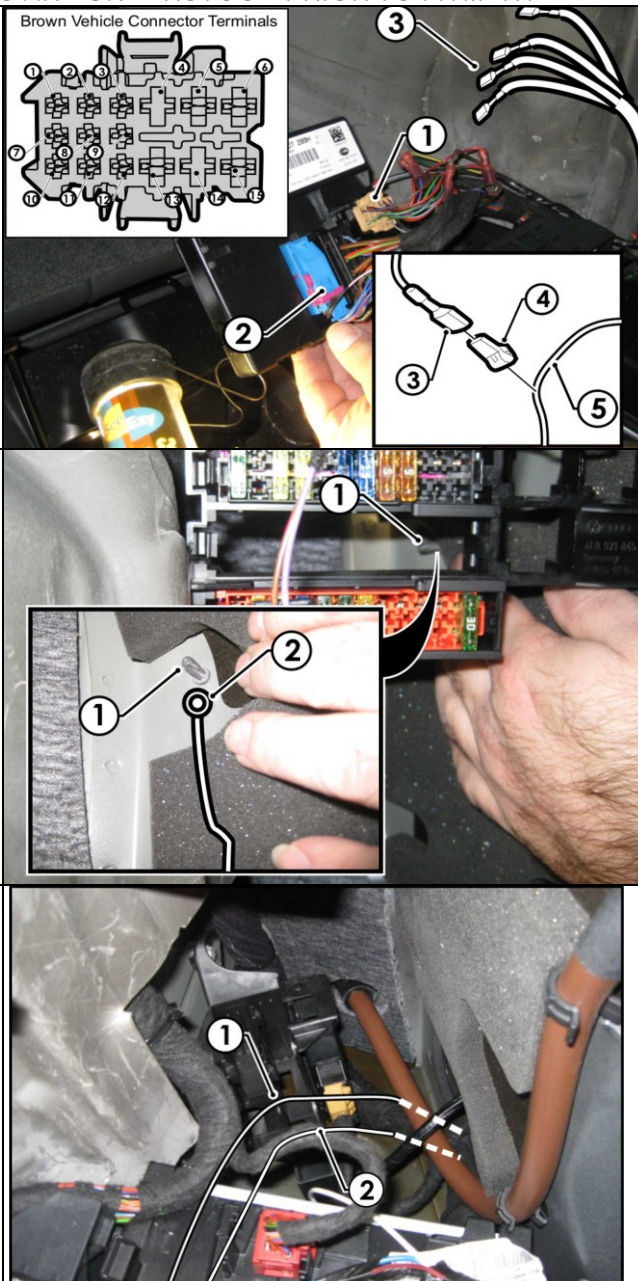

Issue Date 22-12-11

Page 6

Part No: 100418-WL

Hayman Reese (Cequent)  
PO Box 4050, Dandenong South VIC 3164  
Phone 1800 812 017 Email [info@haymanreese.com.au](mailto:info@haymanreese.com.au)

[www.haymanreese.com.au](http://www.haymanreese.com.au)





**HAYMAN REESE**  
**PART No: 100418-WL**  
**AUDI Q7**  
**2009 - Onwards**

## INSTALLATION INSTRUCTIONS

**PLEASE ENSURE THAT INSTRUCTIONS ARE UNDERSTOOD PRIOR TO FITMENT**

19. From the outside of the vehicle, dislodge the RHS rear grommet (3) and pull the vehicle harness through the grommet hole.
20. Cut the tape on the vehicle harness (1) to expose the wires.
21. Route the trailer harness reverse black/white wire terminal (3) through the grommet hole.
22. Connect the trailer harness black/white wire terminal (3) to the ezy tap (4).
23. Re-fit the vehicle harness grommet (2), ensuring it is seated correctly.

Trailer Patch	Vehicle Connector	Function
BLACK/WHITE	GREEN/BROWN	REVERSE

**For the 2011 models only.**

Function	Trailer Patch	Vehicle Connector
BRAKES	RED/BLACK	RED/YELLOW

24. In the luggage compartment, connect the 12-way trailer harness connector (1) to the ECU (2).

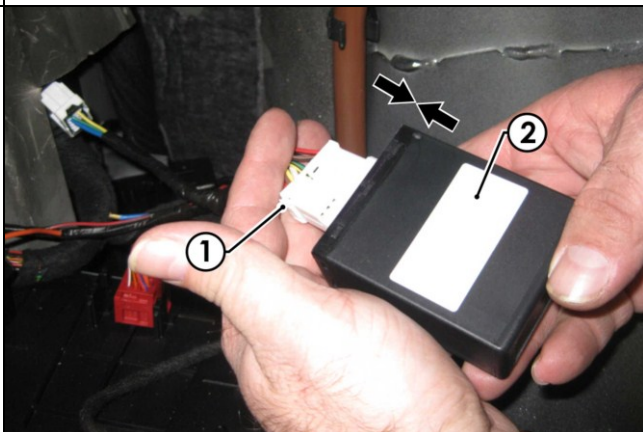
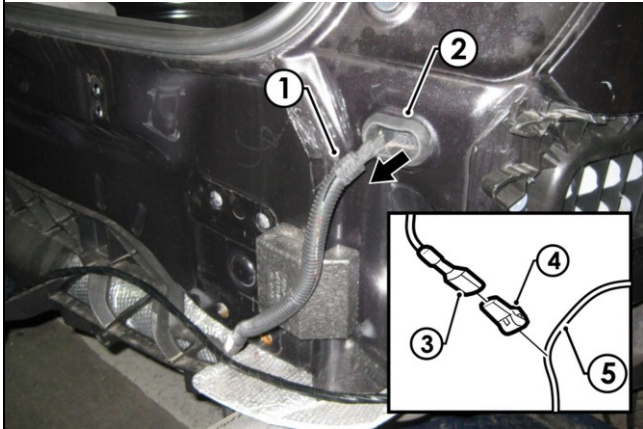

**Issue Date 22-12-11**

**Page 7**

**Part No: 100418-WL**

Hayman Reese (Cequent)  
 PO Box 4050, Dandenong South VIC 3164  
 Phone 1800 812 017 Email [info@haymanreese.com.au](mailto:info@haymanreese.com.au)

[www.haymanreese.com.au](http://www.haymanreese.com.au)



**HAYMAN REESE**  
**PART No: 100418-WL**  
**AUDI Q7**  
**2009 - Onwards**

## **INSTALLATION INSTRUCTIONS**

**PLEASE ENSURE THAT INSTRUCTIONS ARE UNDERSTOOD PRIOR TO FITMENT**

25. Apply double sided tape (1) to the ECU (2).

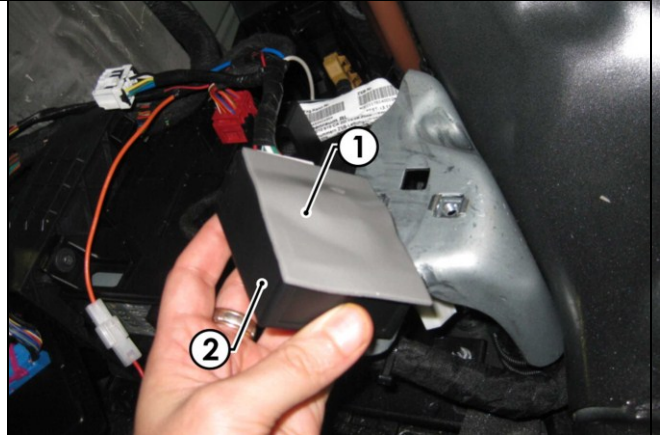

26. Mount the ECU (1) securely to the vehicle sheet metal as shown.

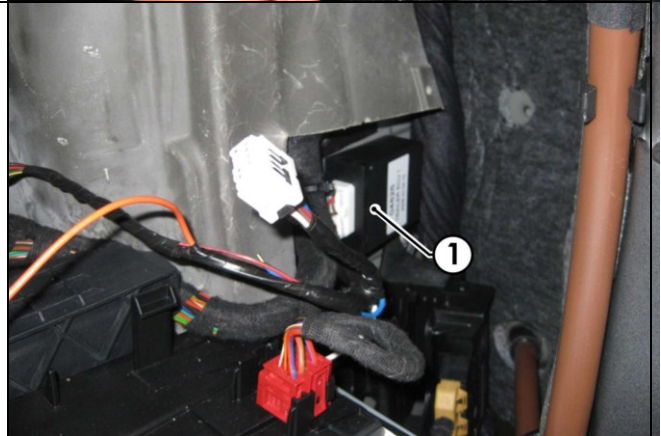

27. From the outside of the vehicle, drill a Ø30mm hole in the area behind the RHS mudflap near the vehicle grommet.  
28. File down any rough or sharp edges and spray on rust inhibitor.  
29. From the outside of the vehicle, route the tail harness (tail length) through the previously drilled grommet hole.  
30. Ensure the tail harness grommet is seated correctly.  
31. Secure the grommet in place with a cable tie (not supplied).

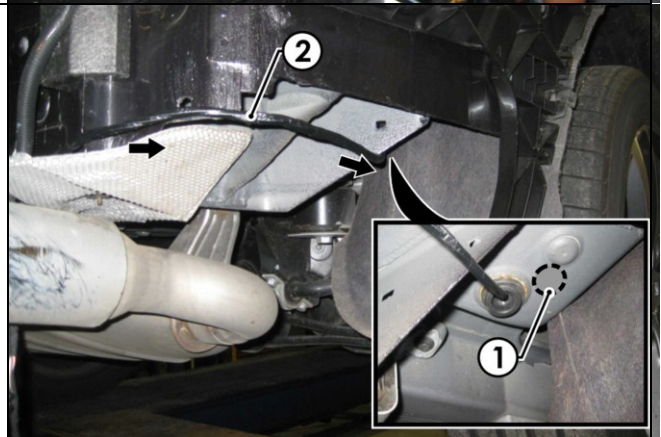

**Issue Date 22-12-11**

**Page 8**

**Part No: 100418-WL**

Hayman Reese (Cequent)  
PO Box 4050, Dandenong South VIC 3164  
Phone 1800 812 017 Email [info@haymanreese.com.au](mailto:info@haymanreese.com.au)



**HAYMAN REESE**  
**PART No: 100418-WL**  
**AUDI Q7**  
**2009 - Onwards**

## **INSTALLATION INSTRUCTIONS**

**PLEASE ENSURE THAT INSTRUCTIONS ARE UNDERSTOOD PRIOR TO FITMENT**

32. Mount the tail harness socket (1) to the towbar mounting bracket using M4 fasteners (not supplied).

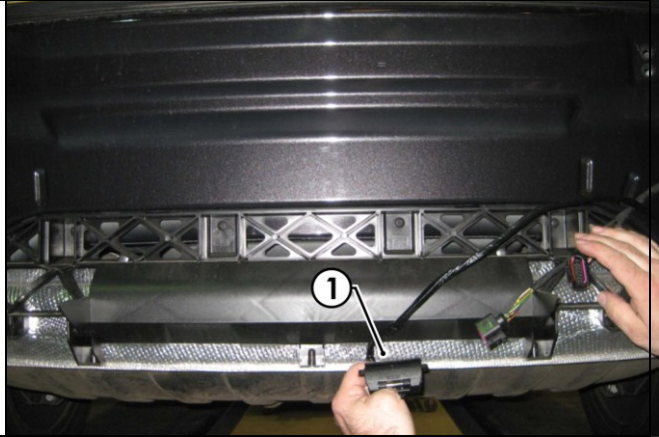

33. Connect the 8-way tail harness connector (1) to the trailer harness 8-way mating connector (2).

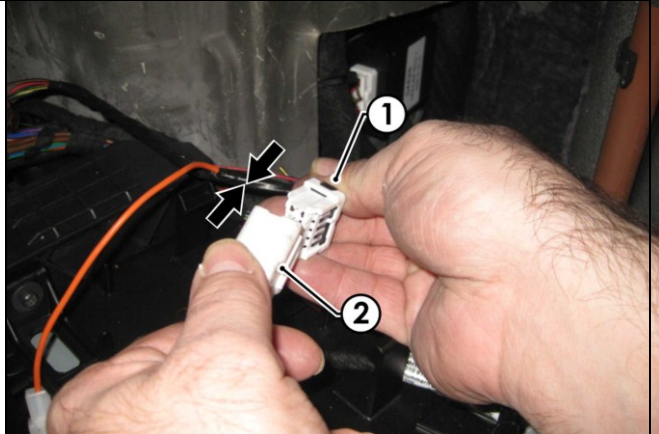

34. Connect the 1-way add-a-fuse harness connector (1) to the 1-way trailer harness mating connector (2).

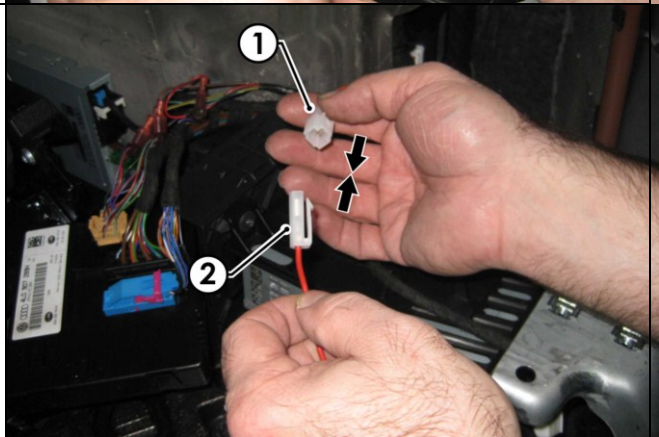

**Issue Date 22-12-11**

**Page 9**

**Part No: 100418-WL**

Hayman Reese (Cequent)  
PO Box 4050, Dandenong South VIC 3164  
Phone 1800 812 017 Email [info@haymanreese.com.au](mailto:info@haymanreese.com.au)

[www.haymanreese.com.au](http://www.haymanreese.com.au)



**HAYMAN REESE**  
**PART No: 100418-WL**  
**AUDI Q7**  
**2009 - Onwards**

## **INSTALLATION INSTRUCTIONS**

**PLEASE ENSURE THAT INSTRUCTIONS ARE UNDERSTOOD PRIOR TO FITMENT**

35. Insert the supplied 20-amp fuse (1) into the upper slot of the add-a-fuse harness (2).
36. Plug the add-a-fuse harness (2) into the available fuse slot on the luggage compartment fuse panel.
37. Note: If the fuse slot is taken, remove the vehicle fuse and put it in the lower slot on the add-a-fuse harness (2).

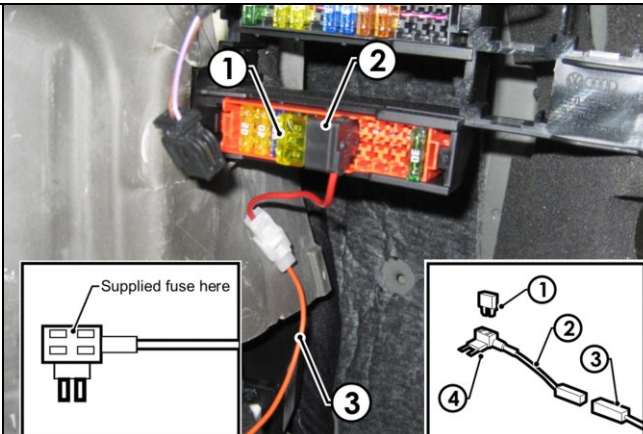

38. Test the trailer harness function using a light board or multimeter.
39. Secure all harness using cable ties (not supplied).
40. Re-fit all removed parts and secure all fasteners, ensuring there are no squeaks or rattles.
41. Place the instructions in the glove box after fitment.

Issue Date 22-12-11

Page 10

Part No: 100418-WL

Hayman Reese (Cequent)  
PO Box 4050, Dandenong South VIC 3164  
Phone 1800 812 017 Email [info@haymanreese.com.au](mailto:info@haymanreese.com.au)

[www.haymanreese.com.au](http://www.haymanreese.com.au)

