

NOTE: Refer to Owner's Manual for maximum carrying capacity of the vehicle. Weight must NOT exceed lower value.

STEP 1: Fitting End Support to Cross-bar

- Insert End Support into Cross-bar.
- Insert Nut into Bottom Slug and then slide both components into the cross-bar.
- Loosely fasten using Bolt, Spring Washer and Flat Washer. Assemble as shown in Fig.1
- Fit End Cap to each end of cross-bar.

COMMERCIAL SERIES

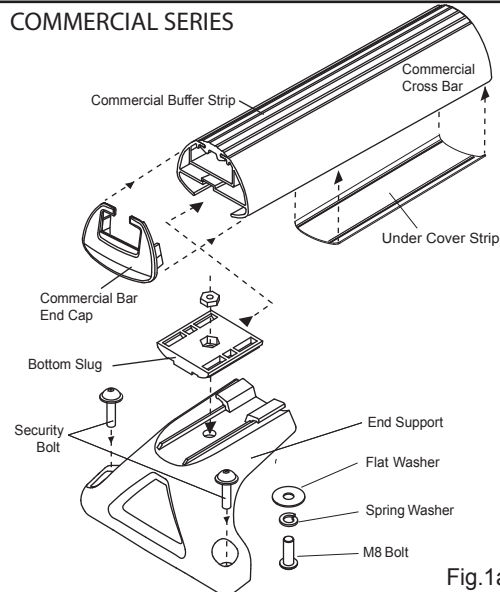

Fig.1a.

SPORTS SERIES

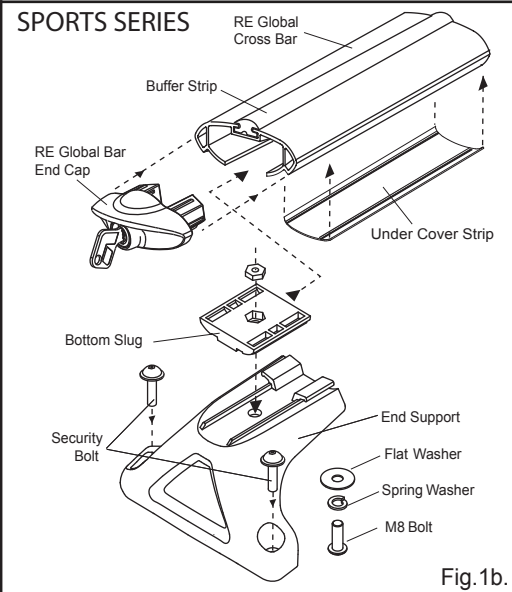

Fig.1b.

STEP 2: Placement of Locking Straps

- Carefully remove black trim covers from each side of roof. To do this, manoeuvre fingers under the covers and slowly pull upwards. The Anchor Points are located above front and rear doors also at the very rear of vehicle. (Fig 2a). They are covered with tape the same colour as the vehicle. There are two Anchor Points at each location. Carefully peel back Tape to expose both threaded Anchor Point. (Fig 2b).
- Use the M6x16mm Bolts to secure Locking Strap to each Anchor Points, Note the orientation of Rubber Washer, Locking Strap to the Special Bolt. (Fig. 2b). Tighten Special Bolts securing Locking Strap to vehicle. A Firm hand tightness is adequate.
- Replace Roof Trims. (See note Below).

Note: Remove the plastic clips from vehicle.

Fig 2a

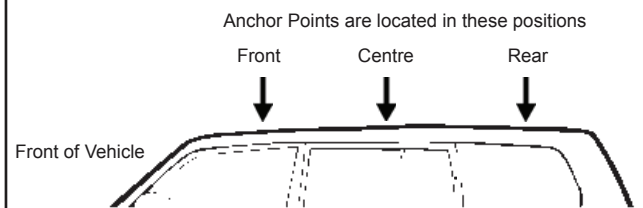
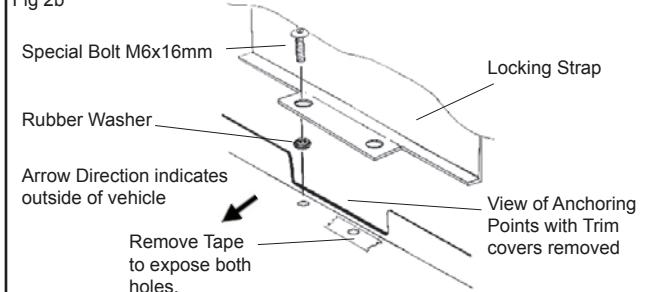

Fig 2b



STEP 3: Fitting Cross Bars to Vehicle.

- Place cross-bar assembly onto appropriate Locking Straps. Loosely fit Special Bolts through End Support and engage Cage Nut. Tighten two or three turns with key supplied. Go to other side of vehicle and fit other End Support the same. (Fig. 3a)
- Measure equal distance (x) between end of cross-bar and End Support on each side of vehicle (Fig 3b.)
- Tighten all bolts including the End Support to Cross-bar fixing bolts assembled in Step 1.

USAGE INSTRUCTIONS

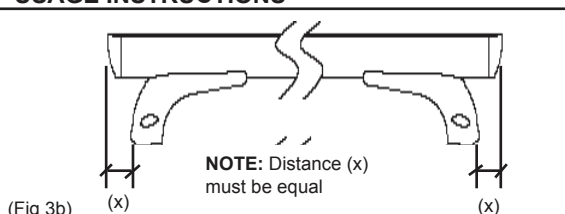

(Fig 3b)

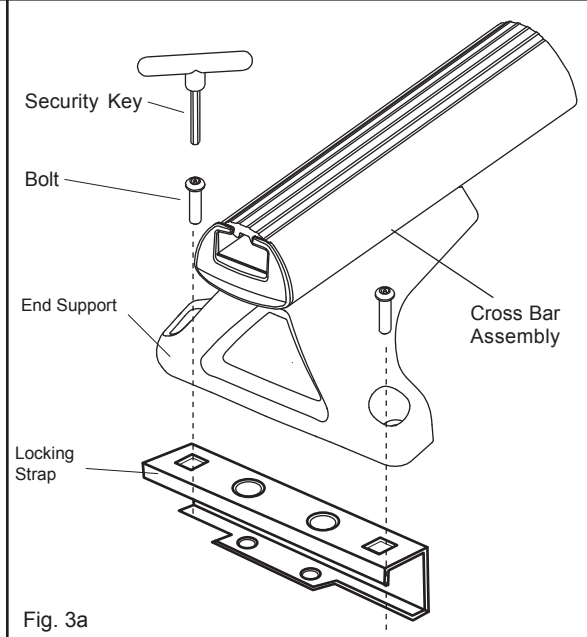

Fig. 3a