



FITTING INSTRUCTIONS
MITSUBISHI TRITON MQ & MR 2016 ON
TITAN LOW MOUNT ANCHOR POINT
PART NUMBER: **LAPEX021-2**











ISSUE: C
ISSUE RELEASE DATE: 10/09/2020

2. KIT CONTENTS

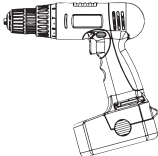
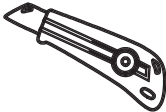
END SUPPORT (MSE017- 2 pack) x4	UNDER-COVER STRIP x2	M8 DROP-&TURN BOLT (22-0924) x4	FLAT WASHER (22-0186) x4	M8 SPRING WASHER (22-0162) x8	
M8 HEX NUT (22-0139) x8	M8 T BOLT (22-0961) x2	27mm STAR BOLT (22-0350) x4	M8 FLAT WASHER (22-0195) x4	COUPLING NUT (22-0937) x4	TT27 ALLEN KEY (22-0811) x1
ADAPTOR PLATE (22-0936) x4	FOAM GASKET (30-0063) x4	HEIGHT ADAPTOR & M8 X 35mm BOLT x2			
LOW MOUNT WITH END CAPS (25-0310 - 2 pack) Each Low Mount contains two end caps x4		INTERLOCKING BLOCK (19-0061) x3			

Prior to assembly, check that your roof rack kit contains all the parts as listed above.
Ensure the vehicle roof is clean and dry.

3. TOOLS AND MATERIALS REQUIRED

		
Flat Head Screwdriver	Rubber Mallet	Drill With 8mm Bit - Use to hole through the weather strip.
	 	
Cutting Knife - Use to open Kits, and trim Buffer Strip to size.	Measuring Rule - Use to check dimensions and distances of cross-bars.	Cleaning/protective Cloth - Use to wipe down vehicle, and use to protect vehicle paint.
		
Marking Pencil - Use to mark buffer strip.	13mm Spanner - Use to assemble Cross Bars.	

4. INSTALLATION STEPS

STEP 1

Note: Refer to Titan Tray instructions for tray assembly.

Skip to Step 4 on the following page if you have already inserted the interlocking blocks.

Place tray upside down.
Remove fasteners on one side and remove the end plank.

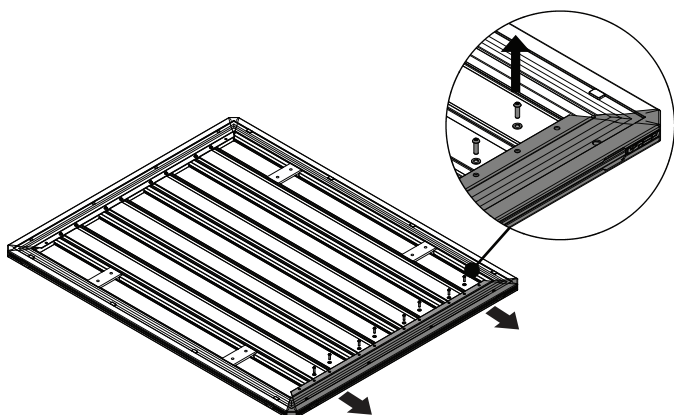

STEP 2

For TFT1212, TFT1512 & TFT1812:
Insert the three interlocking blocks between the four centre planks.

For TFT2014:
Insert the four interlocking blocks between the five centre planks.

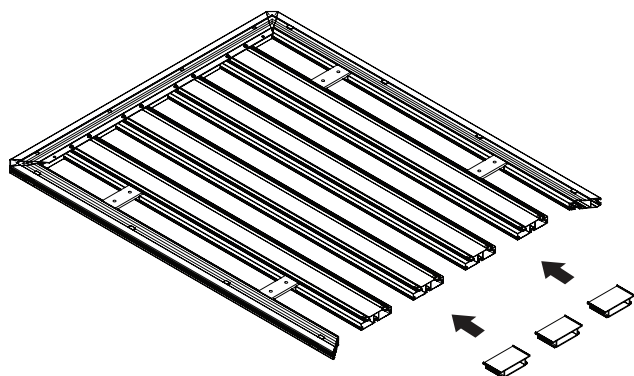

STEP 3

Re-install the end plank and fasteners.

Tighten fasteners securely.

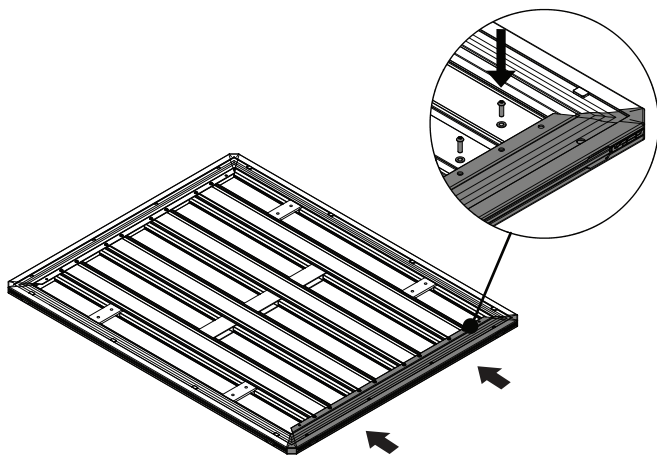

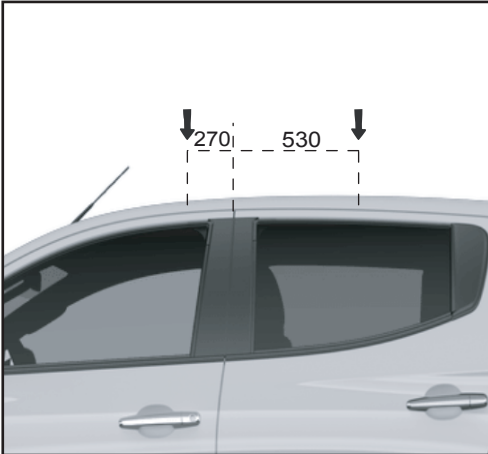

STEP 4

The anchor point locations are indicated by the distances shown. Measurements are taken from the middle of the “B” Pillar.

LIFT WEATHER STRIP

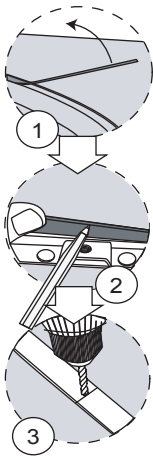

STEP 5

Carefully peel back the plastic weather strip to access the anchor points. Directly above the designated anchor points mark a reference point on the weather strip.

Remove the weather strip completely from the vehicle and drill an 8mm hole through the weather strip at each anchor point position. Ensure the holes aligns with the anchor points on the roof of the vehicle.

Re-fit both weather strips.

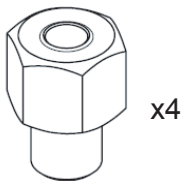

STEP 6

Insert a Coupling Nut into each of the 4 vehicle anchor points. Tighten with a 12mm spanner or socket

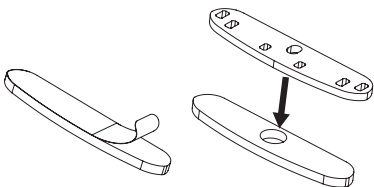

STEP 7

Peel backing off the foam gasket and stick the foam gasket to the adaptor plate.

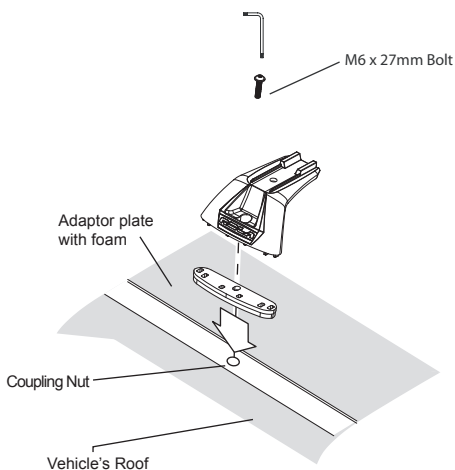

STEP 8

Locate the end support on the adaptor plate with foam gasket on the anchor hole and insert the security bolt. Do not fully tighten yet.



Ensure that the center hole in the adaptor plate lines up with the anchor point thread in the roof.

Repeat for all 4 anchor points.

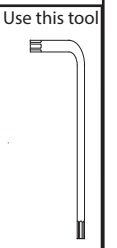

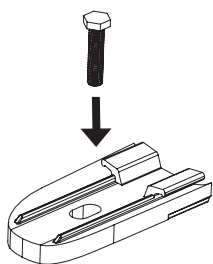

STEP 9

Insert the M8 x 35mm bolt in the height adaptor.
Complete for both height adaptors.

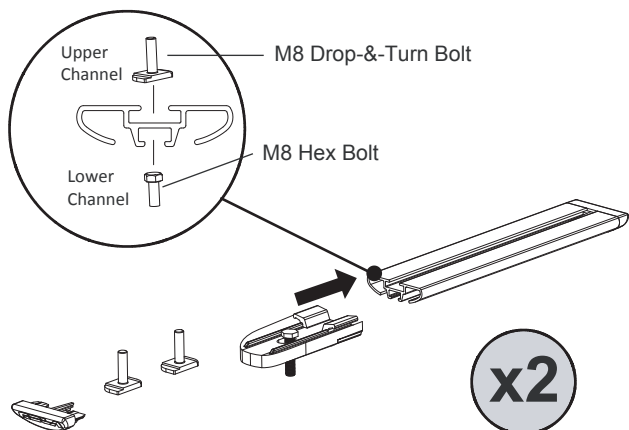

STEP 10

Remove the end cap from one side of the Low Mounts and insert the fasteners, including the height adaptors with the bolts.

Complete for two Low Mounts and height adaptors.

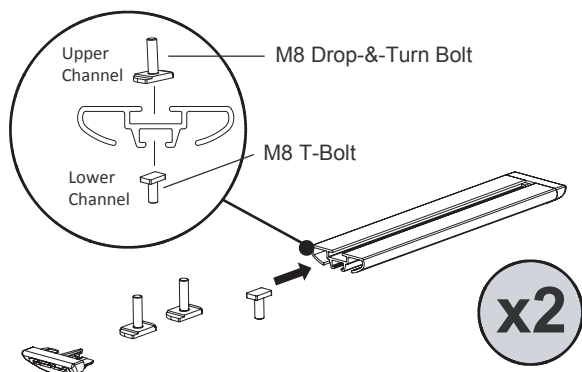

STEP 11

Remove the end cap from one side of the remaining Low Mounts and insert fasteners:
2 x M8 Drop-&-Turn bolt
1 x M8 x 20 T-bolt

Note: Use Drop-&-Turn bolts supplied with Titan Tray in addition to those supplied with this kit.

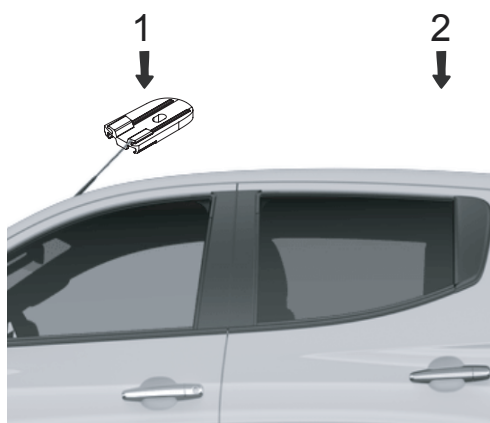

The Low Mounts with the height adaptors will go on the front position on the tray.

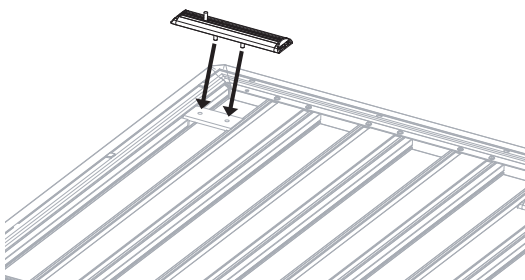

Curved edge of height adaptor to outside of tray/vehicle.

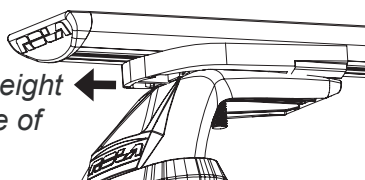

STEP 12

Tip: Work with tray upside down.

Position Low Mounts so the M8 Drop-&-Turn bolts are inserted into the tray mounting blocks.

Place the Low Mounts with the height adaptors in the front position on the tray.

Ensure the height adaptor orientation is correct as shown. The curved edge of the height adaptor must face out when sitting on the end support.

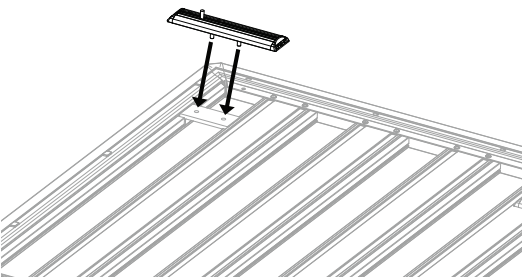

STEP 13

Position Low Mounts so the M8 Drop-&-Turn bolts are inserted into the tray mounting blocks.

Tip: Work with tray upside down.

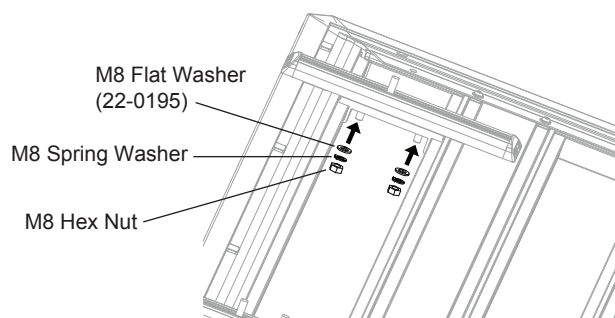

STEP 14

Thread fasteners on drop-&-turn bolts for all locations.

Tip: Leave loose until last step to allow final adjustment.

Note: Use M8 spring washer, flat washer and hex nut supplied with Titan Tray in addition to those supplied with this kit.

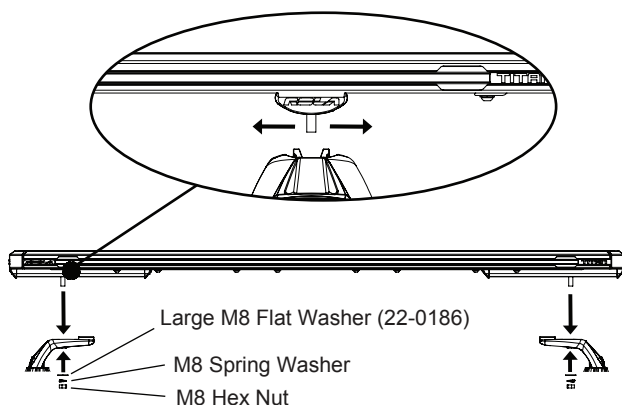

STEP 15

Lift tray above vehicle and slide Low Mounts and Mounting Blocks to line up with end supports.

Lower Titan Tray on to the end supports and ensure tray is centred in the desired location.

Thread the fasteners in place.

Tip: Leave loose until last step to allow final adjustment.

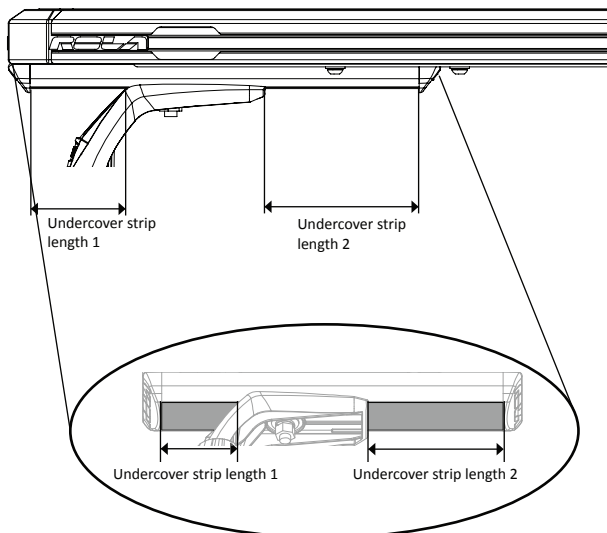

STEP 16

Measure and cut the undercover strip to suit all locations.

Tip: Front and rear lengths may differ in size.

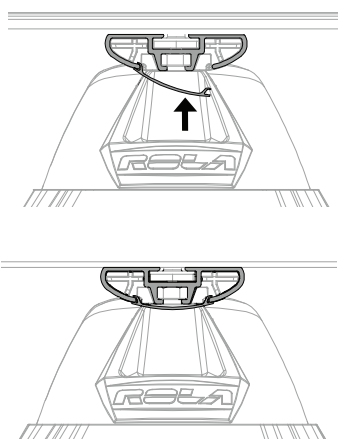

STEP 17

Insert the undercover strip lengths into each Low Mount.



STEP 18

Tighten all fasteners securely.

Your fitment is complete.

USAGE INSTRUCTIONS

It is essential for the proper assembly, operation and use of the Roof-rack that the instructions and safety precautions supplied are strictly observed. The Maximum permissible load for your Roof Bar is the lower of the maximum load capacity specified in you vehicle operation manual, or specified as applying to the Roof-rack. Do not exceed the maximum specified Load capacity.

Maximum Permissible Load = Weight of the Roof-rack + Weight of Accessories + Weight of Load(Cargo).

When fitting the Roof-rack and transporting a load, ensure the vehicle's functions are not impaired (eg. sunroof, aerials, windscreen wipers, mirrors).

Hatch and wagon vehicles should be inspected for adequate clearance for full opening operation of the boot/tailgate.

Stop and check all screw connections, bolts and retaining straps after a short distance of travel. Repeat these checks at regular intervals.

WARNINGS

Remember that the fitting of a Roof-rack and the transport of a load increases the overall height of the carrying vehicle.

Where the roof-rack is to be used in off-road conditions, a safety weight reduction of 1.5 should be observed from the total carrying capacity (eg. 60kg becomes 40kg).

Cequent will not be liable to the purchaser or any other person for any consequential, direct or indirect loss, damage or costs incurred or suffered by the purchaser or any other person including but not limited to damage to persons or property, loss of turnover, loss of profits, loss of business or goodwill arising from or in relation to the assembly and use of the Roof-rack, or the non-observance of the fitting and care instructions.