

END SUPPORT (RIGHT) x2	END SUPPORT (LEFT) x2	BASE PLATE (5mm PL) x4	TRACK PLATE (3mm PL) x4	SNAP-ON COVER x4	SECURITY COVER x4	ALLEN KEY x1	SCREW x4	SECURITY BOLT x4	SECURITY BOLT x4	ASSEMBLY KEY x1	CROSS-BAR ASSEMBLY x2

Please Note: You will require the following tools



Phillips Head Screwdriver



Flat Head Screwdriver



Rubber Mallet

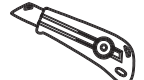

Safety Knife

ASSEMBLY OF CROSS-BARS

1. Ensure the roof is clean, free from dust and grease.
2. Insert the neck of the End-Support into the void of the Cross-bar profile. They are designed to be a tight fit: use a rubber mallet if necessary (Fig.1)
3. Pull back the rubber Buffer Strip about 20mm until the screw hole can be accessed.(Fig. 2) Using a Phillips Head Screwdriver, fasten the screw through the cross-bar and into the End Support. Do this for all four sides and replace the buffer strip.

Fig. 1

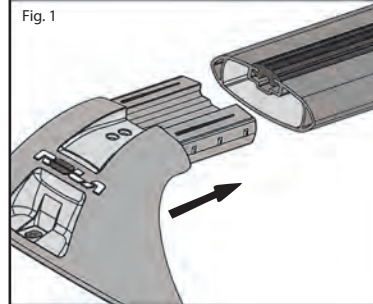
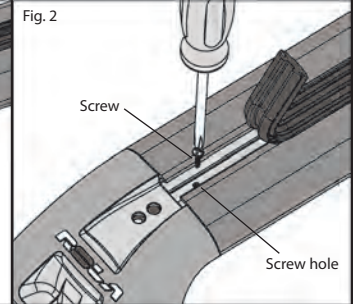

Fig. 2



FITTING CROSS-BARS TO VEHICLE

4. Identify your anchor points and remove factory screws, (if applicable) using tool supplied - refer to Fig 3 & Fig. 4 Remove screws at position 2 and 4 only.
 Keep these factory screws in a safe place.
Position the track and base plates onto the roof in the positions as specified in Fig 4 and Fig 5. Place the Cross-bar assemblies (Front & Rear) in their positions on top of base plates.
5. Ensuring the base plates are aligned with the anchor points and holes in the end supports are corresponding with their positions on the vehicle, (2 & 4) proceed to fasten the end supports in position, using the security bolts provided. (Fig. 4 - 5)
6. Repeat the same procedure for opposite sides of vehicle..
7. Mount your "Accessories" set onto the cross-bars using the Global Mount Channel. Once installed, insert the 'Global Channel' Covers into the End Supports.

Note: You have a choice of 2 - (a) quick access snap-on cover or (b) long term mounting - security cover to cap off and lock the mount channel. (Fig. 5)

Fig. 3

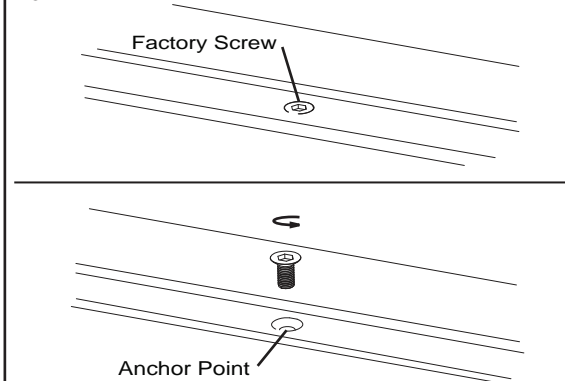
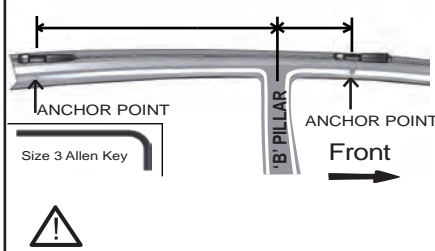

Fig. 4.



POSITIONS

5 4 3 2 1



Fig. 5

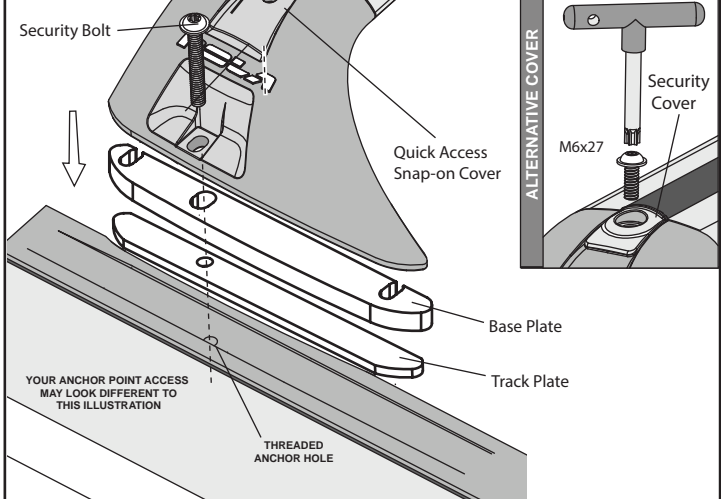

Fig. 6



General Usage Information

It is essential for the proper assembly, operation and use of the Roof Rack that the instructions and safety precautions supplied are strictly observed. Read any fitting, care and usage instruction carefully.

The maximum permissible load for your Roof Bar is the lower of the maximum load capacity specified in your vehicle operation manual, or specified as applying to the Roof-Rack. Do not exceed the maximum specified load capacity.

Maximum permissible load = weight of the Roof Rack + weight of accessories + weight of load (cargo).

When fitting the Roof-Rack and transporting a load, ensure the vehicle's functions are not impaired (eg, sunroof, aerials, windscreen wipers, mirrors). Rear doors on Hatch- and Wagon-type vehicles should be inspected for adequate clearance for full opening operation of the boot/tailgate.

Stop and check all screw connections, bolts and retaining straps after a short distance of travel. Repeat these checks at regular intervals.

Warnings

Remember that the fitting of a Roof Rack and the transport of a load increases the overall height of the carrying vehicle.

Where the Roof-Rack is to be used in off-road conditions, a safety weight reduction of 1.5 should be observed from the total carrying capacity. (eg. 60kg becomes 40kg)

Sequent will not be liable to the purchaser or any other person for any consequential, incidental, direct or indirect loss, damage or costs incurred or suffered by the purchaser or any other person including but not limited to damage to persons or property, loss of turnover, loss of profits, loss of business or goodwill, arising from or in relation to the assembly and use of the Roof rack, or the non-observance of the fitting and care instructions.