

Maximum Carrying Capacity: CTB06-2 = 100kg / CTB06-3 & 4 = ROM (ROM = Refer to TBEX06-2 = 80kg / TBEX06-3 & 4 = ROM Owners Manual)

Part #: CTB06-2,3 & 4 & TBEX06-2,3 & 4

Parts List: Refer to Fig. 1

10-0011 Commercial Cross Bar
or
10-0009 Sports Cross Bar
27-0230 End support ('F' type)
27-0345 Commercial End Cap
or
27-0325 Sports End Cap
27-0116 Bottom Slug
32-0014 Commercial Buffer Strip
or
32-0000 Sports Buffer Strip
32-0020 Under cover strip
22-0496 M8x20mm bolt
22-0139 M8 hex nut
22-0186 M8 flat washer
22-0162 M8 spring washer
22-0349 M6x25mm Security bolt/s
22-0019 Hex Brass nut/s
27-0224 10 Degree Wedge Block
+ BKB 11mm Height Adjuster kit
(only used in 3 & 4 bar system)

COMMERCIAL SERIES

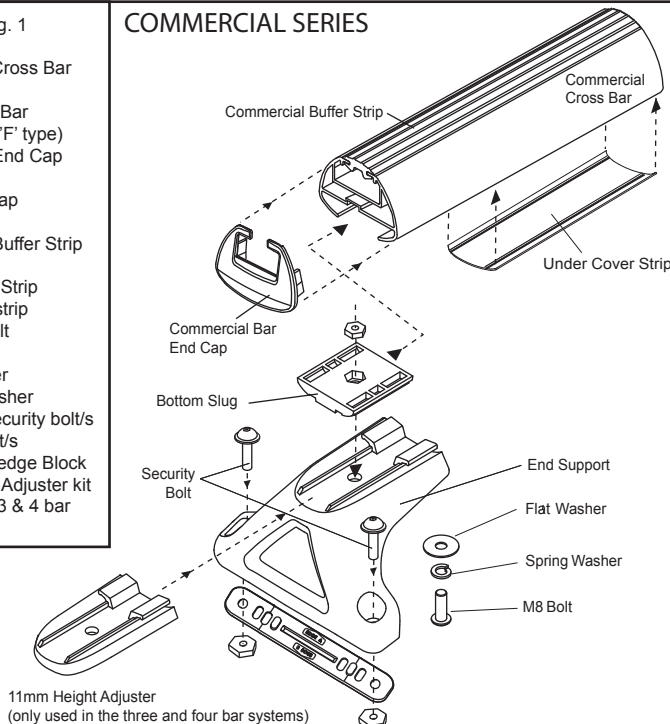

SPORTS SERIES

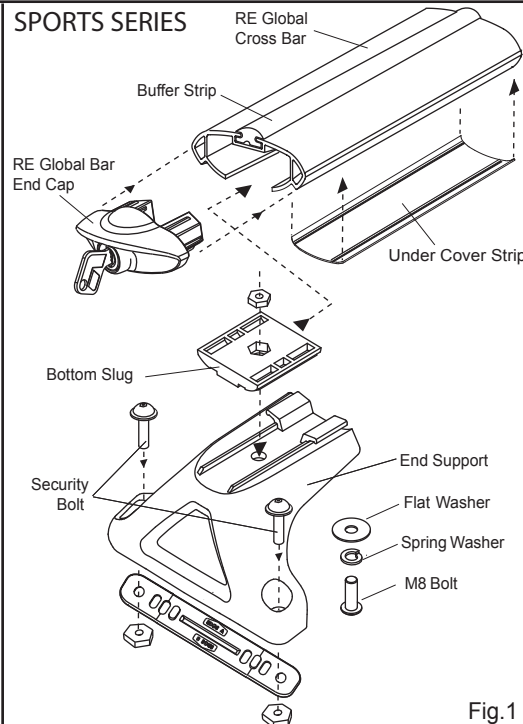

Fig.1

STEP 1: Fitting End Support to Cross Bar

- Insert End Support into Cross Bar.
- Insert Nut into Bottom Slug and then slide both components into Cross Bar.
- Loosely fasten using M8 Bolt, Spring Washer and Flat Washer. Assemble as shown in Fig. 2.
- Fit End Cap to each end of Cross Bar.

Note: If fitting the 11mm height adjuster to make the front/rear level, Refer to supporting Fitting Instructions for assembly assistance.

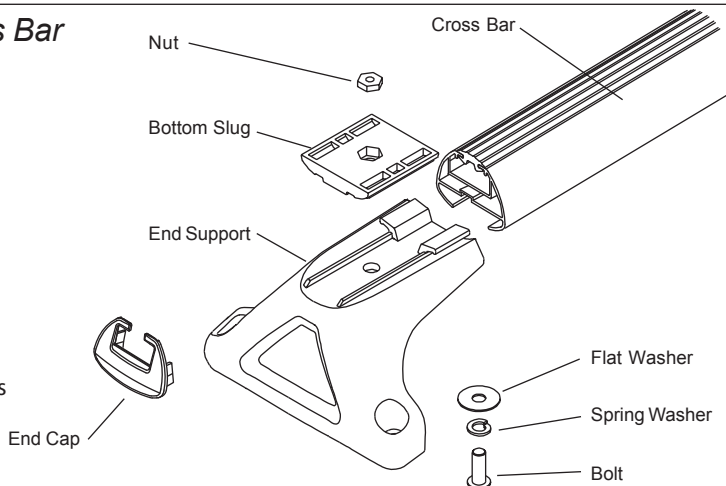

Fig. 2

Note: Drawings for illustration purposes only. Crossbar may be supplied with open endcaps.

STEP 2: Fitting Wedge Block to End Support

- Fit Wedge Block to End Support.
(Orientation shown in Figures 3a & 3b.)

NOTE: The Wedge Block should clip onto End Support.

⚠ It is important that the Wedge Block be assembled in the correct orientation as shown.

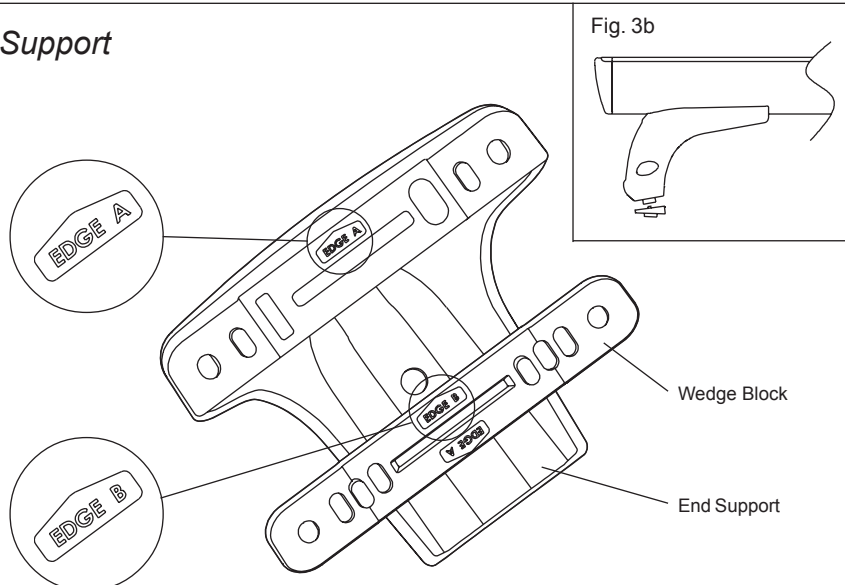

Fig. 3a

Maximum Carrying Capacity: CTB06-2 = 100kg / CTB06-3 & 4 = ROM (ROM = Refer to TBEX06-2 = 80kg / TBEX06-3 & 4 = ROM Owners Manual)

Part #: CTB06-2,3 & 4 & TBEX06-2,3 & 4

STEP 3: Fitting Cross Bars to Tracks

- Place M6 x 25 Security Bolts through End Supports. Thread bolt through Hex Brass Nut and give two to three turns so as nut and bolt assembly is loose.
- Place Cross Bar assembly over the cutout section in the vehicles rails.
- Slide Cross Bar assembly along the rails to required position making sure that the nuts are on the underside of the rail.
NOTE: If Cross Bar is hard to move you may have to loosen the nuts slightly or check that the Cross Bar is perpendicular to the rails.
- Tighten all bolts including the End Support to Cross Bar fixing bolts assembled in Step 1.
NOTE: Make sure that the Brass Nut is placed securely in track away from any of the cutouts in the track. Each End Support is to feature two bolt and nut combinations.

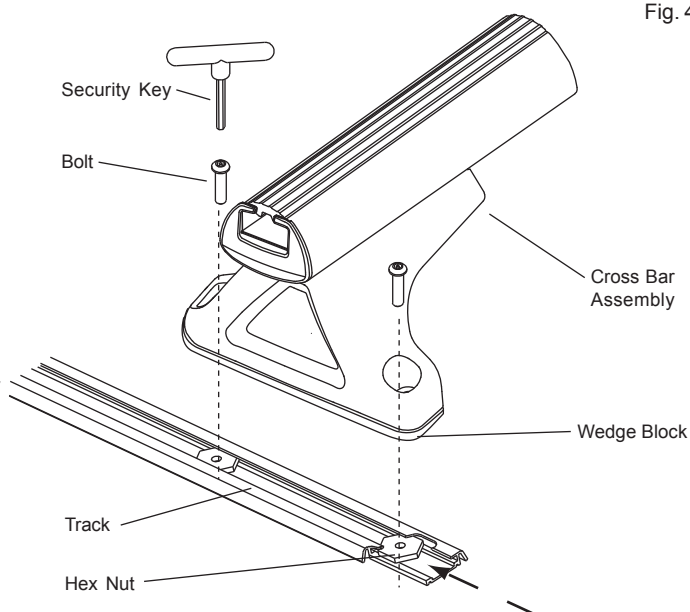

Fig. 4

STEP 4: Measuring Undercover Strip

- Using a tape measure, obtain a size for Dimension X (Fig.5).

NOTE: The Sports bar model will need to be measured from edge of cutout to the end support.

- With the Undercover Strip on a flat surface, mark and cut the length obtained in Step A; using strong scissors.

- Repeat process A & B for front of End Support (Z).

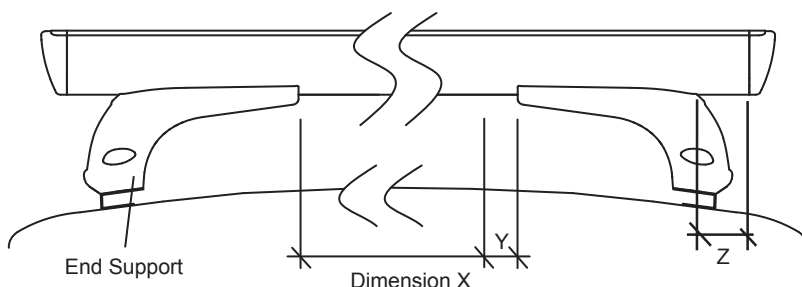
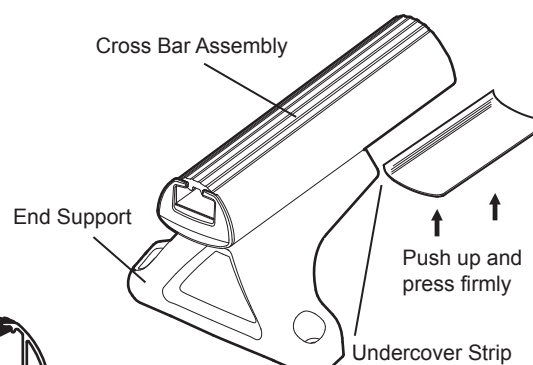

Fig. 5 (Measured between End Supports for H/D type bar (Dim. X) or from End Support to edge of cutout for Sports bar (Y))

Note: Caution should be taken when using sharp blades.

STEP 5: Fitting Undercover Strip

- Place one side of the Undercover Strip into the position under the Cross Bar as shown (Fig.6.a)
- Apply pressure along the opposite edge of the Undercover Strip until the whole length is clipped securely into position (Fig.6.b).



Push up and press firmly



Fig. 6.a

Fig. 6.b